

HAMILTON

UL LISTED TRTL-30 CHEST
 2-HOUR 350 DEGREE FIRE PROTECTION
 IN ACCORDANCE TO UL 72
 REPORT NO: GL 20505

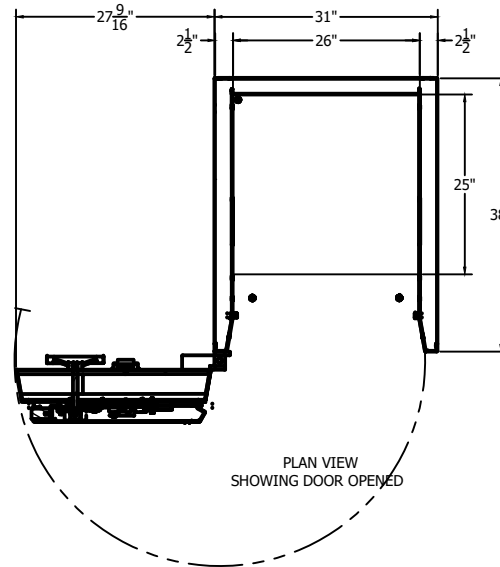
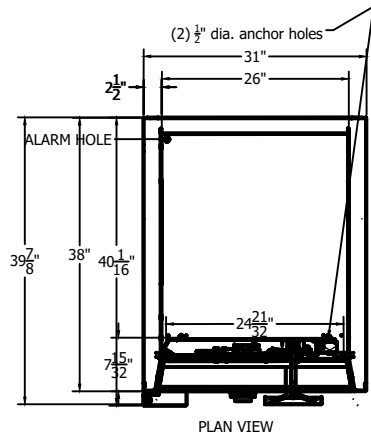

TRTL-30 CHEST 54"H X 31"W X 38"D
 LEFT SWING DOOR
 LOCK: KLD. COMBINATION LOCK

UNIT COLOR: CHARCOAL GRAY
 (2) ANCHOR HOLES 1/2" DIA. IN BOTTOM OF CHEST
 HEAT SENSOR & DOOR CONTACT
 1" BUILT IN BASE IN BOTTOM OF CHEST -
 TO RAISE CUSTOMER BOXES ABOVE BOTTOM STRIKE
 ESTIMATED WEIGHT: 3,668 LBS.

CHEST SHOWS
 THE STORAGE
 OF (4) TEST BOXES
 11"H X 20"W X 27"D

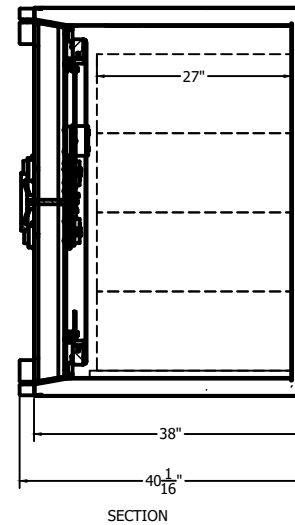
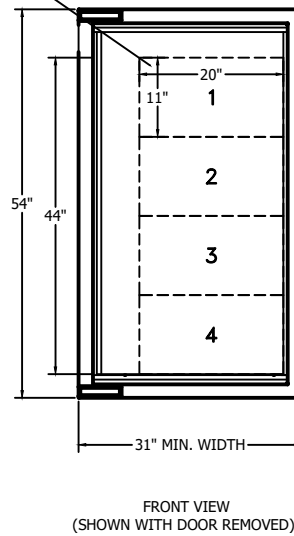
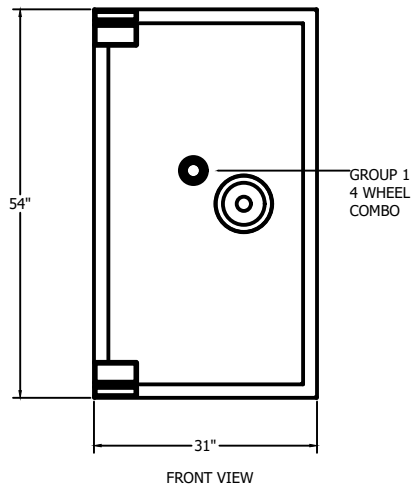

REVISION # 1	
REVISION # 2	
REVISION # 3	

**TEST STORAGE CHEST
 MODEL 19-117 L**

DEALER : KL SECURITY
 DATE : 2-15-18
 ORDER NUMBER : QUOTE
 DRAWING NUMBER :
 DRAWN BY : JOSH STEWART
 SHEET : 1of1

